

**DRAWING REVISIONS**

REV	DOCUMENT	APP	DATE
1	PRELIM.		

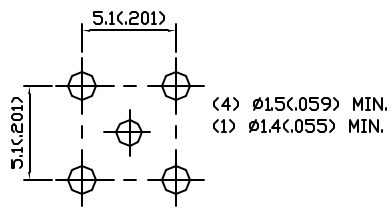

MOUNTING HOLE

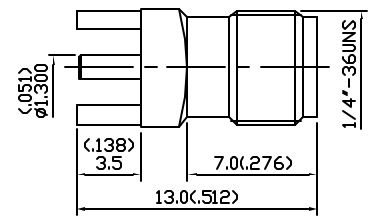
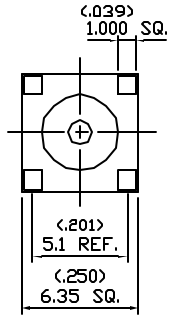

**NOTES**

- SPECIFICATIONS:  
 MATERIALS:  
 BODY: BRASS  
 PLATING: GOLD 3 MICRO INCHES MIN  
 CENTER CONTACT:  $\frac{3}{16}$  Cu  
 PLATING: GOLD 50 MICRO INCHES MIN.  
 INSULATOR: TEFLON  
  
 ELECTRICAL  
  
 IMPEDANCE: 50 Ohms  
 FREQUENCY RANGE: 0 TO 18 GHz  
 WORKING VOLTAGE: <= 100V  
 INSULATION RESISTANCE: >= 5000 MOhms  
 CONTACT RESISTANCE:  
 CENTER CONTACT: 3 MILLI Ohms MAX.  
 OUTER CONTACT: 2 MILLI Ohms MAX.  
  
 MECHANICAL:  
  
 DURABILITY: 500 MATING CYCLES.  
 OPERATING TEMPERATURE: -65°C TO 165°C.  
 CONNECTOR INTERFACE PER MIL-STD-348A  
 2. ALL DIMENSIONS ARE IN MM AND DIMENSIONS IN < > ARE IN INCHES.

CINCH PART NO.	CINCH CATALOG NO.
288 BS 05 001	SMAD-1301

UNITS <b>METRIC</b>		<b>AUTOCAD</b>	<b>Cinch</b>	1700 ENLEY RD LGM BARR, IL 60148
DO NOT SCALE DRAWING	DRAWN BY	DATE D4/28/03	TITLE SMA RECEPTACLE/STRA BOARD MOUNT 50 Ohms.	
<del>ALL DIMENSIONS SPECIFIED DIMENSIONS ARE IN MILLIMETERS</del>	DESIGN ENGINEER A.BALI		MATERIAL SEE TABLE	
<del>PLATE/AND DIA/ MAX</del>	DESIGN ENGINEER'S SIGN		CONTROL SPEC NUMBER	
<del>FINISHING AND MATERIAL</del>	QC ENGINEERING		DRAWING NUMBER C14528	
<del>THIS DRAWING IS THE PROPERTY OF CINCH AND IS NOT TO BE REPRODUCED OR TRANSMITTED IN ANY FORM OR BY ANY MEANS WITHOUT WRITTEN PERMISSION OF CINCH</del>	QUALITY ASSURANCE		SOLD FILE NUMBER SMA50-1301	DRAWING NUMBER <b>SMAD-1301</b>
			DATE REPT REC TIME 7:17PM	SCALE 4:1 SHEET OF 1