

PLUG CONNECTOR, WITH CORD SET AND SEALING GLAND

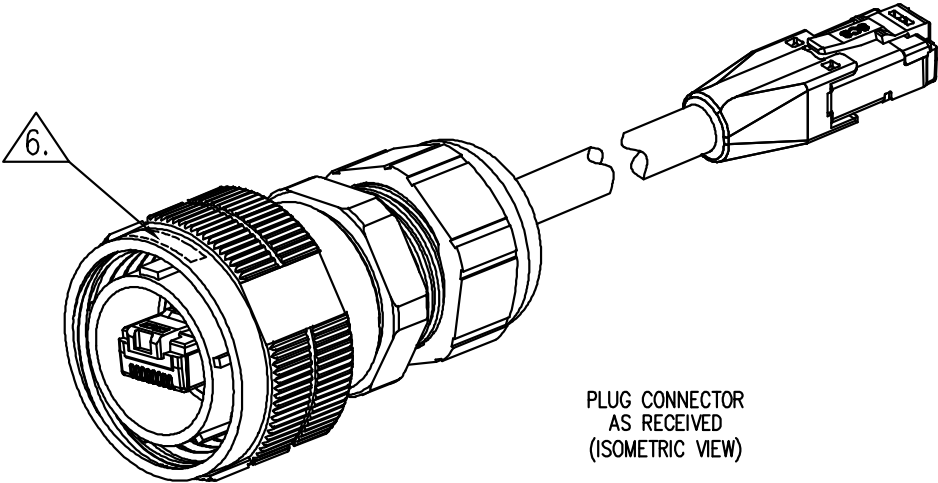

PLUG CONNECTOR  
AS RECEIVED  
(ISOMETRIC VIEW)

PART NUMBER KEY

S-RJFTV6A1906zyyxx

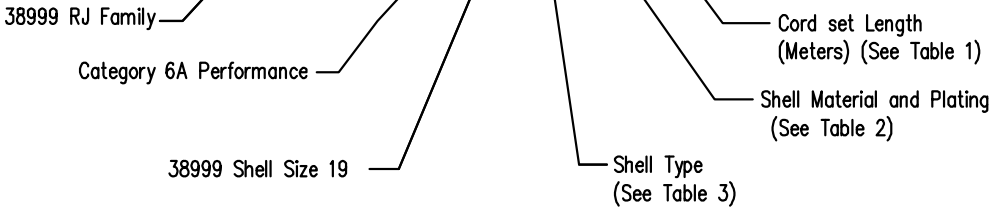
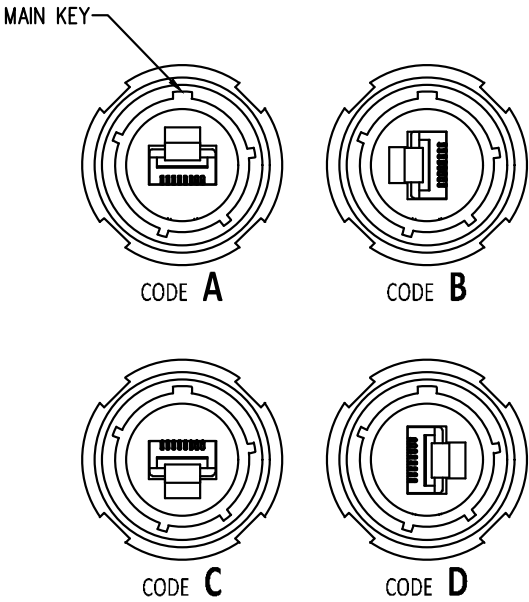

TABLE 1 – CORD SET LENGTH (xx)	
Part Number	Standard Length (Meters) [Inches]
03	0.3 [11.8]
05	0.5 [19.7]
10	1.0 [39.4]
15	1.5 [59.1]
For Lengths Not Shown Follow Part Number Key Format.	

TABLE 2 – SHELL MATERIAL AND PLATING (yy)	
Part Number	Description
G	Aluminum shell, olive drab cadmium plating
N	Aluminum shell, nickel plating (RoHS)
Q	Aluminum shell, black zinc nickel plating (RoHS)
W	Aluminum shell, gray nickel-PTFE plating (RoHS)
SS	Stainless steel, passivated (RoHS)
BZ	Marine bronze (RoHS)



POLARIZATION CODES  
USE REMOVAL TOOL P/N 2940262-01  
IF RECODING IS NECESSARY

TABLE 3 – SHELL TYPE (06z)	
Part Number	Description
06P	Plug, straight, Plastic gland
06M	Plug, straight, Metal gland

- NOTES:
- CONNECTOR MATERIALS:  
SHELL MATERIAL AND PLATING: SEE PART NUMBER KEY AND TABLES  
RJ45 PLUG LOCATOR: THERMOPLASTIC UL94 V-0  
PLUG BODY: CLEAR POLYCARBONATE, UL 94-V0  
LOAD BAR: CLEAR POLYCARBONATE, UL 94-V0  
BOOT: BLACK POLYCARBONATE, UL 94-V0  
CONTACTS: COPPER ALLOY, SELECTIVE GOLD PLATING  
SHIELD: COPPER ALLOY, NICKEL PLATE  
GLAND ASSEMBLY: METAL OR THERMOPLASTIC HOUSING WITH CHLOROPRENE RUBBER SEAL
  - DESIGNED FOR CATEGORY 6A CHANNEL PERFORMANCE (CHANNELS UP TO 50M LONG USING ONLY 1 COUPLER) FOR RJ45 PRODUCT SPECIFICATIONS SEE PR040-01.
  - RJ45 INTERFACE DIMENSIONS AND TOLERANCES COMPLY WITH TIA-1096 STANDARD.
  - CIRCULAR SHELL COMPLIES WITH MIL-DTL-38999.
  - STANDARD PRODUCT IS SUPPLIED ASSEMBLED TO POLARIZATION CODE A
  - CONNECTOR ASSEMBLY IS MARKED WITH DATE CODE IN THIS AREA.
  - CIRCULAR PLUG CONNECTOR IS SUPPLIED WITH DUST CAP.
  - OPERATING TEMPERATURE: -40°C TO +85°C.

THIRD ANGLE PROJECTION

DO NOT SCALE DRAWING  
DRAWING IS SUBJECT TO  
CHANGE WITHOUT NOTICE

DIMENSIONS: INCHES [METRIC]

SHEET NO. 1 OF 3

11118 Susquehanna Trail South  
Glen Rock, PA 17327-9199  
(717) 235-7512  
<http://www.stewartconnector.com>

TOLERANCES UNLESS OTHERWISE SPECIFIED  
.X ± .1 [2.54]  
.XX ± .01 [0.254]  
.XXX ± .005 [0.127]  
ANGULAR ± 1°

THIS DRAWING AND THE SUBJECT MATTER SHOWN THEREON ARE CONFIDENTIAL AND THE PROPRIETARY PROPERTY OF STEWART CONNECTOR AND SHALL NOT BE REPRODUCED, COPIED, OR USED IN ANY MANNER WITHOUT PRIOR WRITTEN CONSENT OF STEWART CONNECTOR. ONE OR MORE U.S. PATENTS MAY APPLY TO THIS PRODUCT. FOR DETAILS, PLEASE VISIT: [HTTP://BELFUSE.COM/STEWART/STEWART\\_PATENTS/](http://BELFUSE.COM/STEWART/STEWART_PATENTS/)

TITLE: CATEGORY 6A IP68 PLUG FOR RJ45 CABLE ASSEMBLY  
SIZE 19 38999, WITH SEALING GLAND

DRN BY: KAW	DATE 09-20-23
APPD BY: GWL	DATE 10-23-23
DWG NO. CT600205	REV. A1

B

A

B

A

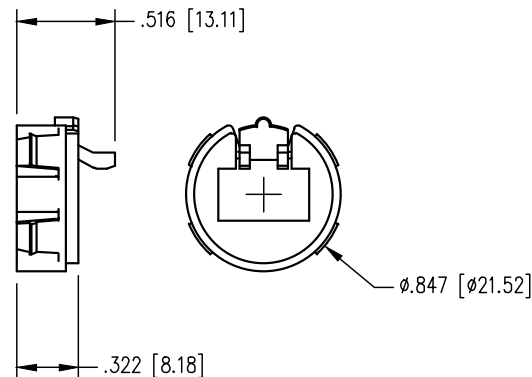
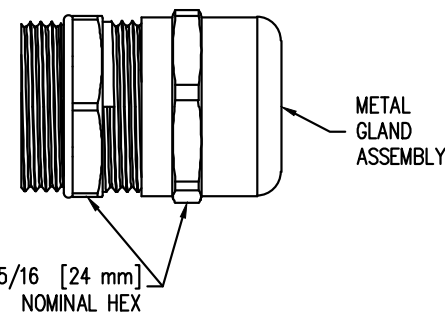
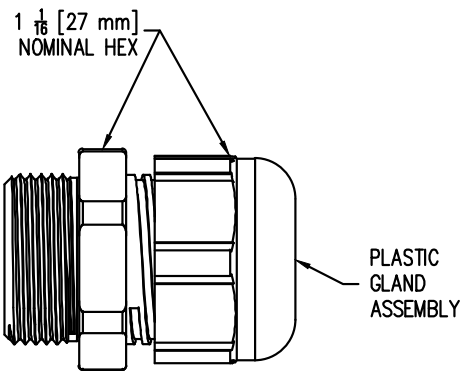
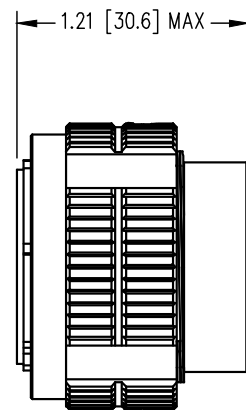
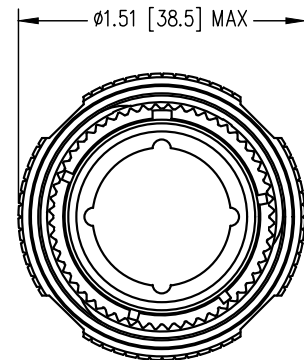
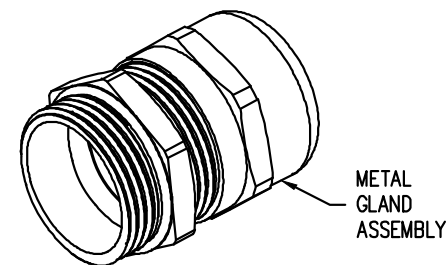

TABLE 4 - CORD SET LENGTH TOLERANCE	
Cable Length = Meters [inches]	Tolerance = MM [inches]
0.5 [19.7] TO 2.5 [98.4]	+100 [3.90] / -0 [0.00]
3.0 [118] TO 10 [394]	+150 [5.91] / -0 [0.00]



PLASTIC GLAND ASSEMBLY

RJ45 CORD SET

LENGTH IN METERS  
(SEE TABLE 1 ON SHT 1)  
(SEE TABLE 4 FOR LENGTH  
TOLERANCE)

RJ45 PLUG LOCATOR

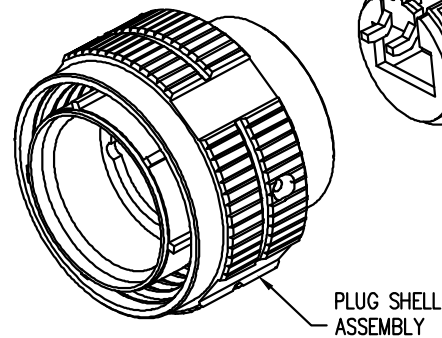

PLUG SHELL  
ASSEMBLY

PLUG CONNECTOR  
AS RECEIVED  
(EXPLODED VIEW)

NOTES:

1. SEALING GLAND RECOMMENDED TORQUE VALUES:

PLASTIC GLAND:

GLAND TO SHELL = 44.3 In-Lbs [5 Nm]  
GLAND TO CABLE = 29.2 In-Lbs [3.3 Nm]

METAL GLAND:

GLAND TO SHELL = 66.4 In-Lbs [7.5 Nm]  
GLAND TO CABLE = 44.3 In-Lbs [5 Nm]

THIRD ANGLE PROJECTION

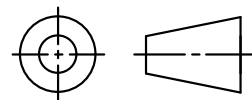

DO NOT SCALE DRAWING  
DRAWING IS SUBJECT TO  
CHANGE WITHOUT NOTICE

DIMENSIONS: INCHES [METRIC]

TOLERANCES UNLESS  
OTHERWISE SPECIFIED  
.X ± .1 [2.54]  
.XX ± .01 [0.254]  
.XXX ± .005 [0.127]  
ANGULAR ± 1°

SHEET NO. 2 OF 3

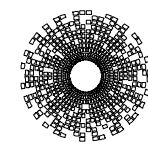

**stewart**  
CONNECTOR  
a bel group

11118 Susquehanna Trail South  
Glen Rock, PA 17327-9199  
(717) 235-7512

<http://www.stewartconnector.com>

TITLE: CATEGORY 6A IP68 PLUG FOR RJ45 CABLE ASSEMBLY  
SIZE 19 38999, WITH SEALING GLAND

THIS DRAWING AND THE SUBJECT MATTER SHOWN THEREON  
ARE CONFIDENTIAL AND THE PROPRIETARY PROPERTY OF  
STEWART CONNECTOR AND SHALL NOT BE REPRODUCED,  
COPIED, OR USED IN ANY MANNER WITHOUT PRIOR WRITTEN  
CONSENT OF STEWART CONNECTOR. ONE OR MORE U.S. PATENTS  
MAY APPLY TO THIS PRODUCT. FOR DETAILS, PLEASE  
VISIT: [HTTP://BELFUSE.COM/STEWART/STEWART\\_PATENTS/](http://BELFUSE.COM/STEWART/STEWART_PATENTS/)

DRN BY:	KAW	DATE	09-20-23
APPD BY:	GWL	DATE	10-23-23
DWG NO.	CT600205	REV.	A1

PLUG CONNECTOR KIT, WITH UNTERMINATED RJ45 PLUG

PART NUMBER KEY

S-RJFTV6A1906zyy

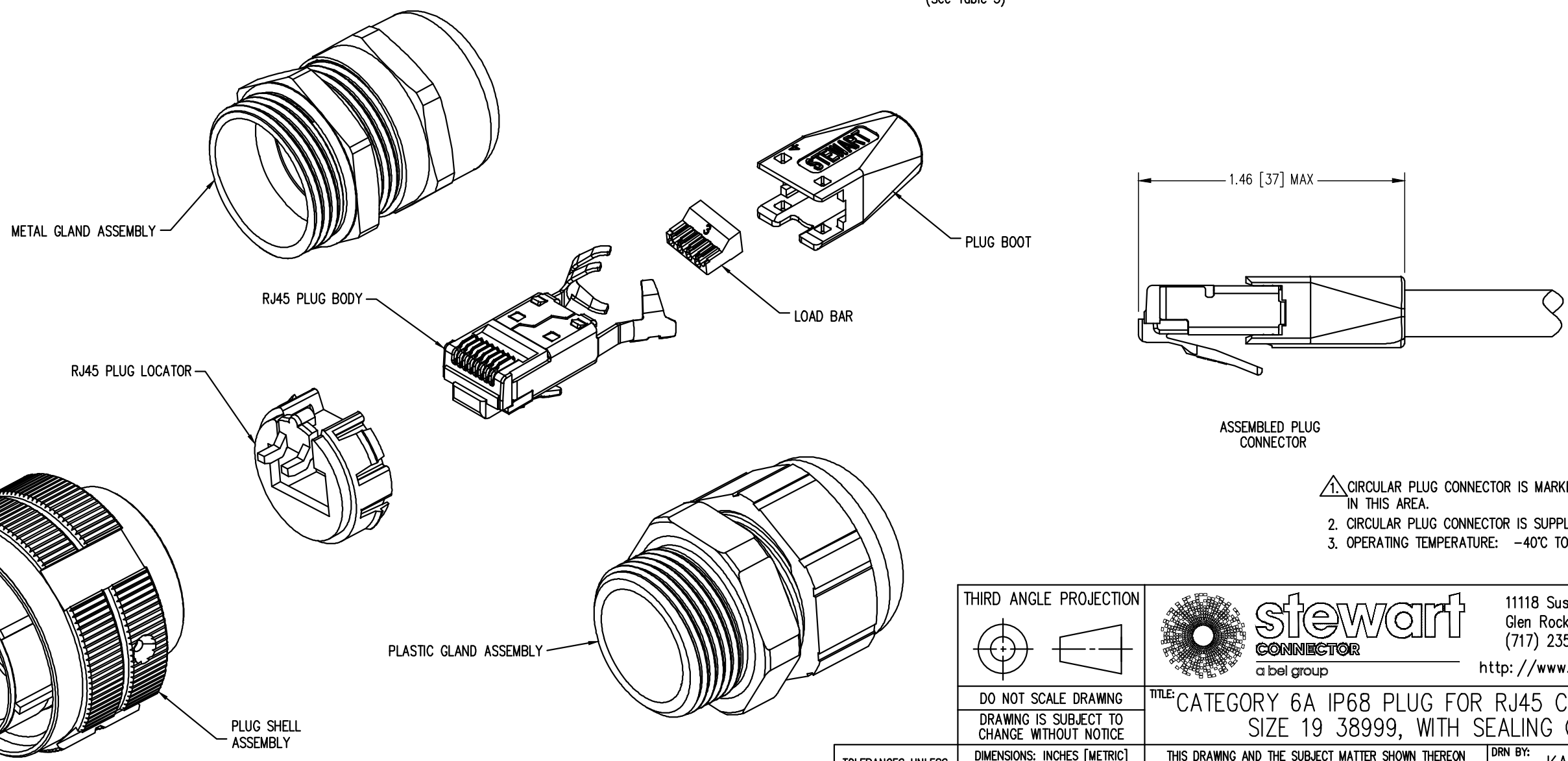
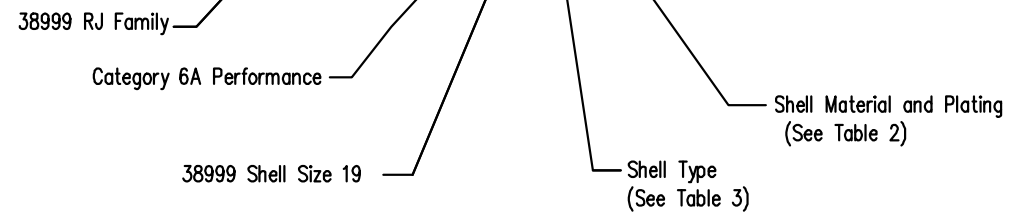

- 1. CIRCULAR PLUG CONNECTOR IS MARKED WITH DATE CODE IN THIS AREA.
- 2. CIRCULAR PLUG CONNECTOR IS SUPPLIED WITH DUST CAP(S).
- 3. OPERATING TEMPERATURE: -40°C TO +85°C.

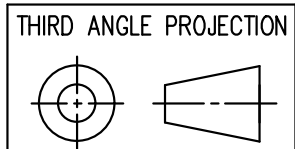

DO NOT SCALE DRAWING  
DRAWING IS SUBJECT TO  
CHANGE WITHOUT NOTICE

DIMENSIONS: INCHES [METRIC]  
  
SHEET NO. 3 OF 3



11118 Susquehanna Trail South  
Glen Rock, PA 17327-9199  
(717) 235-7512  
<http://www.stewartconnector.com>

TITLE: CATEGORY 6A IP68 PLUG FOR RJ45 CABLE ASSEMBLY  
SIZE 19 38999, WITH SEALING GLAND

TOLERANCES UNLESS  
OTHERWISE SPECIFIED  
.X ± .1 [2.54]  
.XX ± .01 [0.254]  
.XXX ± .005 [0.127]  
ANGULAR ± 1°

THIS DRAWING AND THE SUBJECT MATTER SHOWN THEREON  
ARE CONFIDENTIAL AND THE PROPRIETARY PROPERTY OF  
STEWART CONNECTOR AND SHALL NOT BE REPRODUCED,  
COPIED, OR USED IN ANY MANNER WITHOUT PRIOR WRITTEN  
CONSENT OF STEWART CONNECTOR. ONE OR MORE U.S. PATENTS  
MAY APPLY TO THIS PRODUCT. FOR DETAILS, PLEASE  
VISIT: [HTTP://BELFUSE.COM/STEWART/STEWART\\_PATENTS/](http://BELFUSE.COM/STEWART/STEWART_PATENTS/)

DRN BY:	KAW	DATE	09-20-23
APPD BY:	GWL	DATE	10-23-23
DWG NO.	CT600205	REV.	A1