

PANEL CUT-OUT

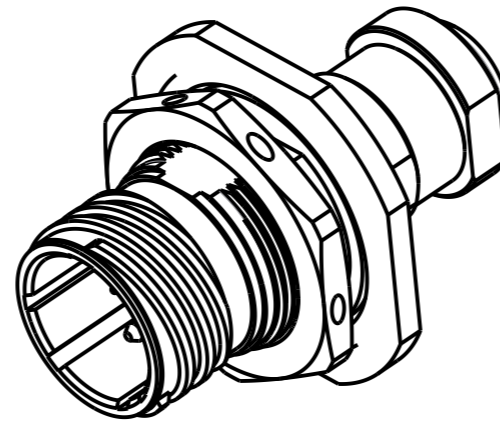

NOTE:

- 38999 PANEL HOUSING KEY POLARIZATION - 'N' HOUSING MAY BE SUPPLIED IN OTHER POLARIZATIONS.
- CABLE DIAMETER:  $\varnothing 0.25\text{mm}$  TO  $\varnothing 0.9\text{mm}$
- FOR SHELL KIT REFER TO PART NUMBERING SCHEME: WI 81-65
- MT FERRULE KIT SUPPLIED SEPARATELY, SEE PART NUMBERING SCHEME: WI 81-66

CONNECTOR MATERIAL OPTIONS

MATERIAL	FINISH
ALUMINIUM ALLOY	ZINC COBALT
STAINLESS STEEL 316L	PASSIVATE
NICKEL ALUMINIUM BRONZE	NON-REFLECTIVE SHOT BLAST

RECOMMENDED PANEL DIMENSIONS

SHELL SIZE	B +0.00/-0.25	$\varnothing C$ +0.25/-0.00
11	19.59 (0.771)	20.96 (0.825)

UNLESS OTHERWISE STATED:  
ALL DIMENSIONS ARE IN mm

CONFIDENTIAL - THE INFORMATION CONTAINED  
IN THIS DRAWING IS THE SOLE PROPERTY OF  
CINCH CONNECTIVITY SOLUTIONS LTD. ANY  
REPRODUCTION IN PART OR AS A WHOLE WITHOUT  
THE WRITTEN PERMISSION OF CINCH CONNECTIVITY  
SOLUTIONS LTD IS PROHIBITED

Cinch Connectivity Solutions LTD  
11 BILTON ROAD, CHELMSFORD, ESSEX. CMI 2UP  
TEL: +44 (0) 1245 342060

THIRD ANGLE  
ORIGINAL: A3  
SCALE: NTS

ISSUE	CHANGE DESCRIPTION	DRN	CHKD	DATE
I	PRODUCTION RELEASE	MEH	GM	05/04/23
A	FIRST ISSUE	MEH	GM	13/06/23

DRAWN MEH	MATERIAL SEE BOM	FINISH SEE BOM	ASSEMBLIES TO BE CLEAN & FREE FROM ALL BURRS & SHARP EDGES
CHECKED GM			

DRAWING TITLE  
MT JAM NUT RECEPTACLE LOW PROFILE  
D38999 TYPE III #11 - CUSTOMER OUTLINE

DRAWING NUMBER  
7062-C

SHEET 1  
OF 1