

2X SMA FEMALE
PER MIL-STD-348
FIGURE 310-2

NUT HEX 5/16

5/16 HEX

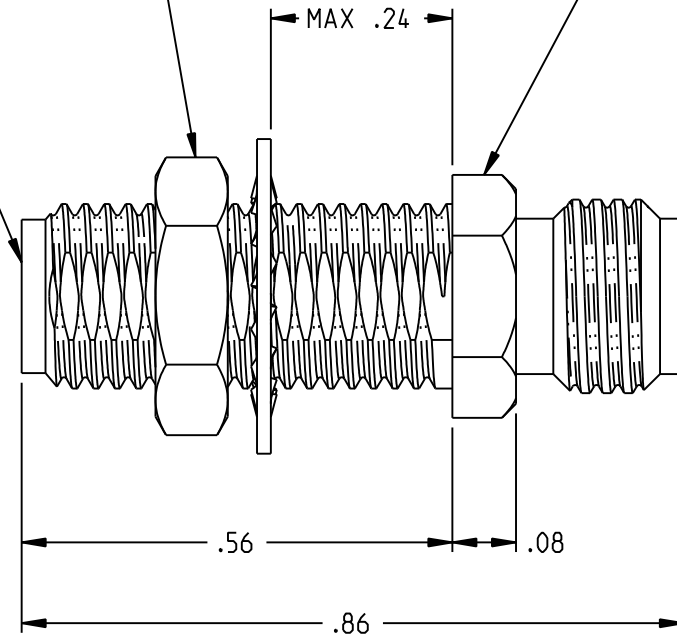

NOTES: UNLESS OTHERWISE SPECIFIED

1. MATERIALS AND FINISH
 - 1.1 BODY AND NUT: GOLD PLATED BRASS
 - 1.2 CENTER CONTACT: GOLD PLATED BERYLLIUM COPPER
 - 1.3 WASHER: GOLD PLATED BRASS
 - 1.4 INSULATOR: PTFE

2. ELECTRICAL SPECIFICATIONS:
 - 2.1 FREQUENCY RANGE: DC TO 18 GHz
 - 2.2 IMPEDANCE: 50 OHMS NOMINAL
 - 2.3 VSWR (MAXIMUM): 1.25 : 1

		MIDWEST MICROWAVE	
	RoHS2 <input checked="" type="checkbox"/> 2015/863/EU	Title: SMA FEMALE TO FEMALE BULKHEAD ADAPTOR	
<small>NOTICE: The information in this drawing is PROPRIETARY and must not be used without the permission of Cinch Connectivity Solutions. It may contain data whose export is restricted. Verify status prior to exporting.</small>		Model No. CGM-1180-FB-SMA-09	
<small>UNLESS OTHERWISE SPECIFIED UNITS: INCH</small>		Size A	Date: 05/21/2021
<small>INTERPRET DRAWING IN ACCORDANCE WITH ASME Y14.5-2018</small>		DO NOT SCALE DRAWING	Sheet 1 OF 1