

REV	ECO	DATE
1	ECO-19-0006	2/26/2019
1A	ECO-19-0032	7/25/2019
2	EC-2511012	11/26/2025

PART NUMBER	ITEM ① BODY	ITEM ② CONTACT	ITEM ③ INSULATOR
145-0701-841	BRASS GOLD PL .00003 MIN OVER NICKEL PL.00005 MIN OVER COPPER	BERYLLIUM COPPER GOLD PL .00005 MIN OVER NICKEL PL.00005 MIN OVER COPPER	TEFLON

SPECIFICATION:

ELECTRICAL:
 IMPEDANCE: 50 OHMS
 FREQUENCY RANGE: 0-40 GHz
 VSWR: 1.5 MAX
 INSERTION LOSS: 0.05 \sqrt{F} dB MAX (F IN GHz)
 WORKING VOLTAGE: 250 VRMS MAX AT SEA LEVEL
 DIELECTRIC WITHSTANDING VOLTAGE: 1000VRMS MIN AT SEA LEVEL
 INSULATION RESISTANCE: 5000 MEGOHM MIN
 CONTACT RESISTANCE:
 CENTER CONTACT - INITIAL 3 MILLIOHM MAX, AFTER
 ENVIRONMENTAL NOT APPLICABLE
 OUTER CONDUCTOR - INITIAL 2 MILLIOHM MAX, AFTER
 ENVIRONMENTAL NOT APPLICABLE
 RF LEAKAGE: -90dB TYPICAL AT 2.5GHz

MECHANICAL:
 ENGAGEMENT/DISENGAGEMENT FORCE: 2 INCH-POUNDS MAX
 MATING TORQUE: 7 TO 10 INCH-POUNDS
 DURABILITY: 500 CYCLES MIN

ENVIRONMENTAL:
 OPERATING TEMPERATUR: -40 TO 85°C
 THERMAL SHOCK: MIL-STD-202, METHOD 107, CONDITION B
 CORROSION: MIL-STD-202, METHOD 101, CONDITION B
 SHOCK: MIL-STD-202, METHOD 213, CONDITION I
 VIBRATION: MIL-STD-202, METHOD 204, CONDITION D
 MOISTURE RESISTANCE: MIL-STD-202, MEHTOD 106

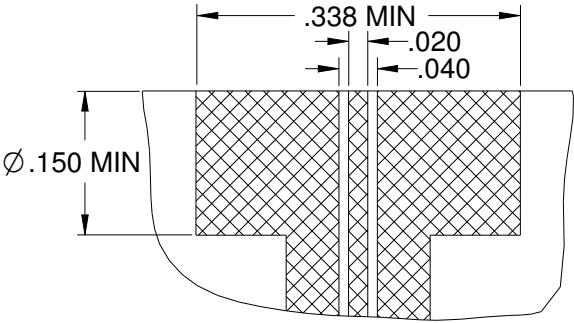

RECOMMENDED PCB LAYOUT

NOTE: THIS PATTERN IS FOR REFERENCE ONLY.
 PATTERN MAY VARY DEPENDING ON ASSEMBLY
 PROCESS, BOARD TYPE, OR SPECIFIC ELECTRICAL OR
 MECHANICAL REQUIREMENTS.

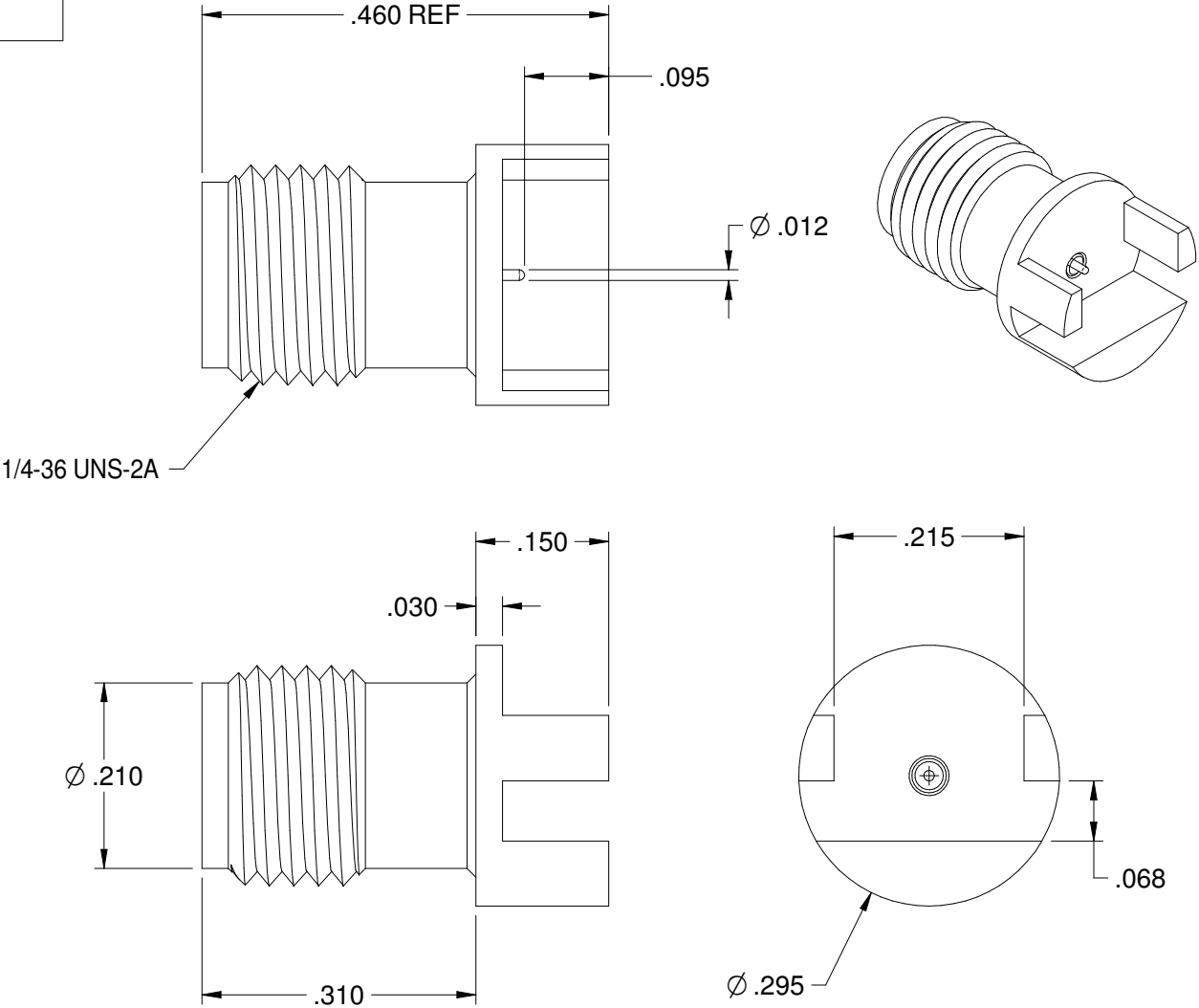

<p>The PROPRIETARY Documents is property of Cinch Connectivity Solutions. Its contents are not to be reproduced, stored in a retrieval system, or transmitted, in any form or by any means, without the prior written permission of Cinch Connectivity Solutions.</p> <p>INTERPRET DRAWING IN ACCORDANCE WITH ASME Y14.5-2018.</p>	Material: SEE NOTE	Model No. 145-0701-841	JOHNSON	
	<p>RoHS2 <input checked="" type="checkbox"/> 2011/65/EU</p> <p>Finish: SEE NOTE Workmanship Size</p>	<p>UNLESS OTHERWISE SPECIFIED .XX ±.01 .XXX ±.003 .XXXX ±.0010 ANGLES ±1°00'</p>	<p>Cage Code</p> <p>3RD ANGLE PROJECTION</p> <p>Drawn By: R.SHEN</p> <p>Date: 2/26/2019</p>	<p>Title: 2.92mm END LAUNCH JACK FOR .062" BOARD</p> <p>Drawing No. 145-0701-841</p> <p>Size B DO NOT SCALE DRAWING</p> <p>Rev. 2</p> <p>Sheet 1 of 1</p>