

NOTES: UNLESS OTHERWISE SPECIFIED:

1. MATERIAL & FINISH:
 - 1.1 BODY: TIN PLATED BRASS
 - 1.2 INSULATOR & DIELECTRIC: PTFE (TEFLON)
 - 1.3 INTERMEDIATE CONTACT: GOLD PLATED BRASS
 - 1.4 CENTER CONTACT: GOLD PLATED BERYLLIUM COPPER
 - 1.5 MOUNTING HARDWARE: NICKEL PLATED COPPER ALLOY
2. ELECTRICAL:
 - 2.1 FREQUENCY (MAX): 500 MHZ
 - 2.2 IMPEDANCE: NON-CONSTANT
4. PANEL NUT TORQUE (MAX): 30 INCH POUNDS
5. PANEL THICKNESS (MAX): .125

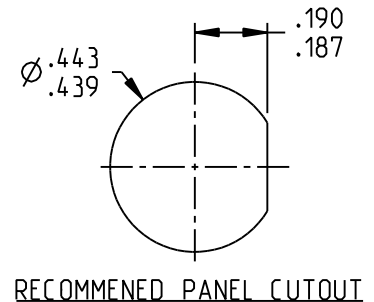
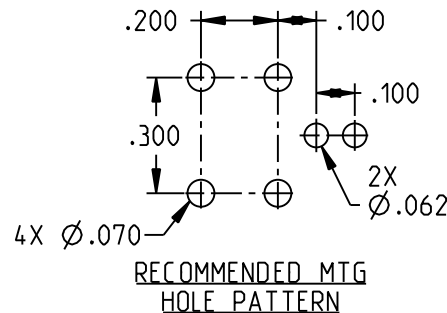

	3RD ANGLE PROJECTION 	TROMPETER	
	RoHS2 <input checked="" type="checkbox"/> 2015/863/EU	Title: TRS, RIGHT ANGLE BULKHEAD, CIRCUIT BOARD JACK	
<small>NOTICE: The information in this drawing is PROPRIETARY and must not be used without the permission of Cinch Connectivity Solutions. It may contain data whose export is restricted. Verify status prior to exporting.</small>		Model No. CBBJR159	
<small>UNLESS OTHERWISE SPECIFIED UNITS: INCH</small>		Size A	Date: 1/10/2023
INTERPRET DRAWING IN ACCORDANCE WITH ASME Y14.5-2018		DO NOT SCALE DRAWING	Sheet 1 OF 1